

3  2P+⊕	4  3P+⊕	5  3P+N+⊕	<b>100-130V</b> 50 a. 60Hz	<b>200-250V</b> 50 a. 60Hz	<b>345-415V</b> 50 a. 60Hz	<b>480-500V</b> 50 a. 60Hz	<b>&gt;50-500V</b> 100-300Hz	<b>&gt;50-500V</b> 300-500Hz
3pol. 4h 4pol. 4h 5pol. 4h	3pol. 6h 4pol. 9h 5pol. 9h	3pol. 9h 4pol. 6h 5pol. 6h	3pol. 7h 4pol. 7h 5pol. 7h	3pol. 10h 4pol. 10h 5pol. 10h	3pol. 2h 4pol. 2h 5pol. 2h			

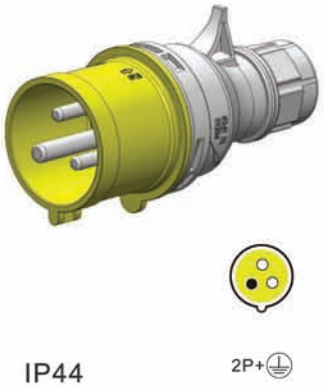

IP44

2P+⊕

**C013-4**  
**C023-4**

電壓 Voltage(V):100-130V~  
防護等級 Protection degree: IP44

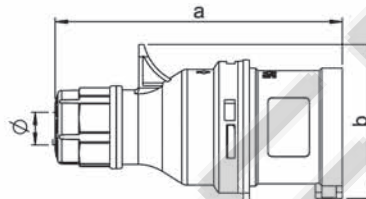
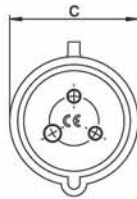

Type	C013-4	C023-4
Rated current(A)	16	32
Dimension(mm)	a	112
	b	55
	c	49.5
	φ	8-14
Cable nominal cross-section area(mm <sup>2</sup> )	1-2.5	2.5-6



IP44

2P+⊕

**C013**  
**C023**

電壓 Voltage(V):200-250V~  
防護等級 Protection degree: IP44

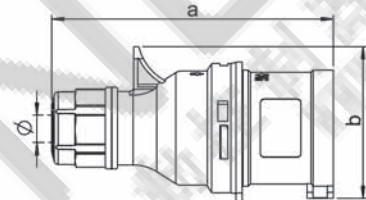
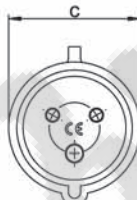

Type	C013	C023
Rated current(A)	16	32
Dimension(mm)	a	112
	b	55
	c	49.5
	φ	8-14
Cable nominal cross-section area(mm <sup>2</sup> )	1-2.5	2.5-6

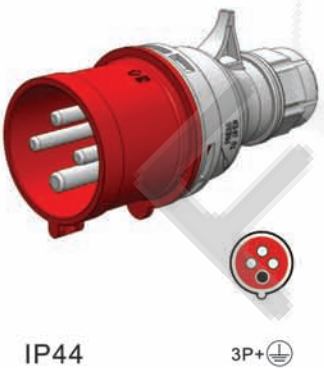

IP44

3P+⊕

**C014**  
**C024**

電壓 Voltage(V):380-415V~  
防護等級 Protection degree: IP44

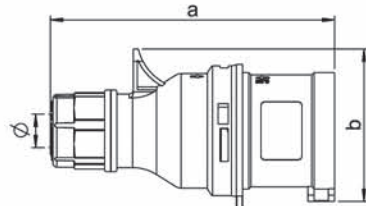

Type	C014	C024
Rated current(A)	16	32
Dimension(mm)	a	116
	b	63
	c	56
	φ	8-14
Cable nominal cross-section area(mm <sup>2</sup> )	1-2.5	2.5-6

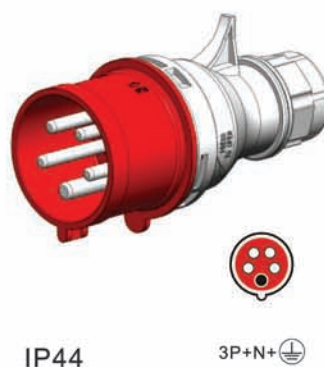

IP44

3P+N+⊕

**C015**  
**C025**

電壓 Voltage(V):  
200-346V~  
240-415V~  
防護等級 Protection degree: IP44

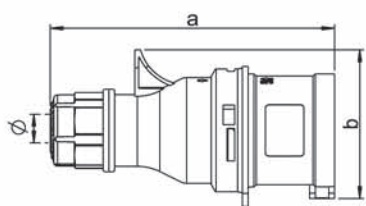

Type	C015	C025
Rated current(A)	16	32
Dimension(mm)	a	125.5
	b	71
	c	63.5
	φ	10-19.5
Cable nominal cross-section area(mm <sup>2</sup> )	1-2.5	2.5-6

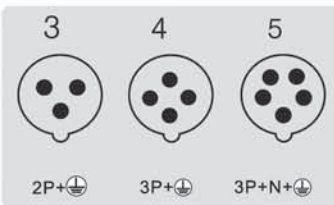

**100-130V**

50 a.60Hz

3pol. 4pol. 5pol.  
4h 4h 4h

**200-250V**

50 a.60Hz

3pol. 4pol. 5pol.  
6h 9h 9h

**346-415V**

50 a.60Hz

3pol. 4pol. 5pol.  
9h 6h 6h

**480-500V**

50 a.60Hz

3pol. 4pol. 5pol.  
7h 7h 7h

**>50-500V**

100-300Hz

3pol. 4pol. 5pol.  
10h 10h 10h

**>50-500V**

300-500Hz

3pol. 4pol. 5pol.  
2h 2h 2h

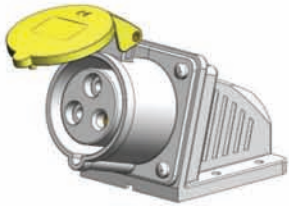

**C113-4  
C123-4**

電壓 Voltage(V):100-130V~  
防護等級 Protection degree: IP44

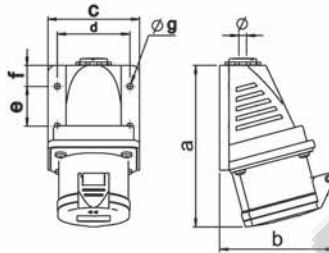

Type	C113-4	C123-4
Rated current(A)	16	32
Dimension(mm)	a	119.5
	b	83.5
	c	74
	d	58
	e	34
	f	10
	g	5.5
	φ	8-14
Cable nominal cross-section area(mm <sup>2</sup> )	1-2.5	2.5-6

IP44

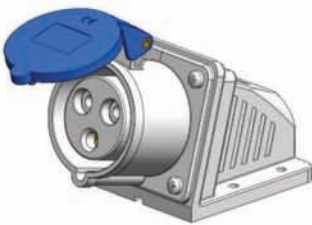

**C113  
C123**

電壓 Voltage(V):200-250V~  
防護等級 Protection degree: IP44

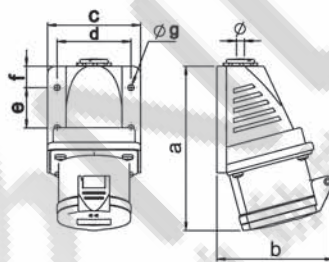

Type	C113	C123
Rated current(A)	16	32
Dimension(mm)	a	119.5
	b	83.5
	c	74
	d	58
	e	34
	f	10
	g	5.5
	φ	8-14
Cable nominal cross-section area(mm <sup>2</sup> )	1-2.5	2.5-6

IP44

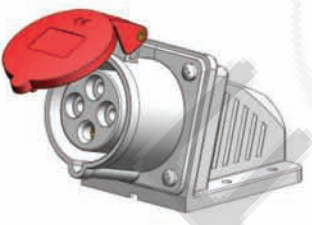

**C114  
C124**

電壓 Voltage(V):380-415V~  
防護等級 Protection degree: IP44

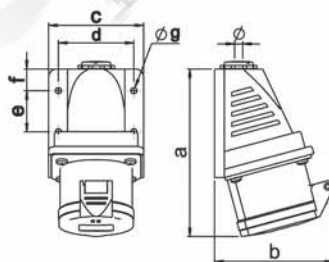

Type	C114	C124
Rated current(A)	16	32
Dimension(mm)	a	120.5
	b	87.5
	c	74
	d	58
	e	34
	f	10
	g	5.5
	φ	8-14
Cable nominal cross-section area(mm <sup>2</sup> )	1-2.5	2.5-6

IP44

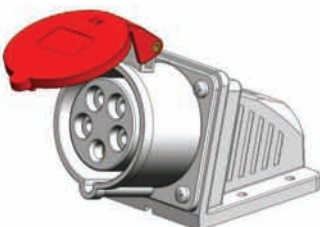

**C115  
C125**

電壓 Voltage(V): 200-346V~  
240-415V~  
防護等級 Protection degree: IP44

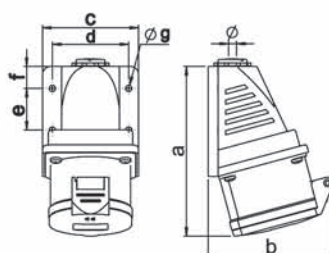

Type	C115	C125
Rated current(A)	16	32
Dimension(mm)	a	121
	b	99
	c	74
	d	58
	e	34
	f	10
	g	5.5
	φ	10-19.5
Cable nominal cross-section area(mm <sup>2</sup> )	1-2.5	2.5-6

IP44



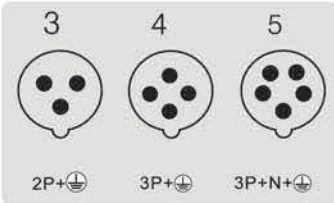

**100-130V**

50 a.60Hz

3pol. 4pol. 5pol.  
4h 4h 4h

**200-250V**

50 a.60Hz

3pol. 4pol. 5pol.  
6h 9h 9h

**346-415V**

50 a.60Hz

3pol. 4pol. 5pol.  
9h 6h 6h

**480-500V**

50 a.60Hz

3pol. 4pol. 5pol.  
7h 7h 7h

**>50-500V**

100-300Hz

3pol. 4pol. 5pol.  
10h 10h 10h

**>50-500V**

300-500Hz

3pol. 4pol. 5pol.  
2h 2h 2h

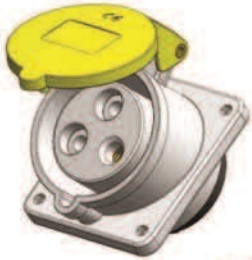

IP44

2P+

**C413-4**  
**C423-4**

電壓  
防護等級

Voltage(V):100-130V~  
Protection degree: IP44

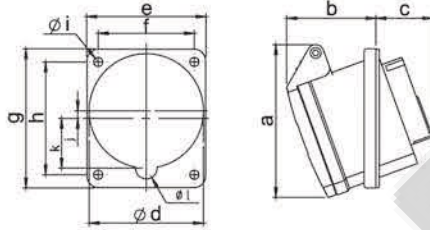

Type	C413-4	C423-4
Rated current(A)	16	32
Dimension(mm)	a	72
	b	43
	c	29
	d	53
	e	78.5
	f	62.5
	g	68
	h	54
	i	7
	j	3
	k	22
	l	13
Cable nominal cross-section area(mm <sup>2</sup> )	1-2.5	2.5-6



IP44

2P+

**C413**  
**C423**

電壓  
防護等級

Voltage(V):200-250V~  
Protection degree: IP44

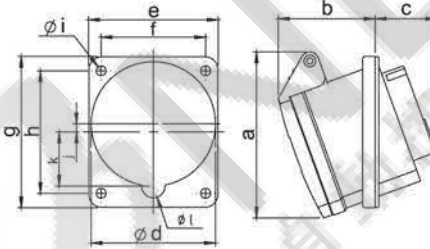

Type	C413	C423
Rated current(A)	16	32
Dimension(mm)	a	72
	b	43
	c	29
	d	53
	e	78.5
	f	62.5
	g	68
	h	54
	i	7
	j	3
	k	22
	l	13
Cable nominal cross-section area(mm <sup>2</sup> )	1-2.5	2.5-6

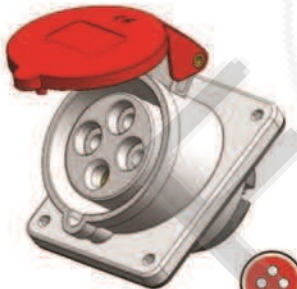

IP44

3P+

**C414**  
**C424**

電壓  
防護等級

Voltage(V):380-415V~  
Protection degree: IP44

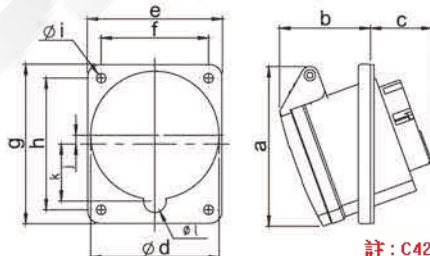

註: C424-9H e:78 f:62

Type	C414	C424
Rated current(A)	16	32
Dimension(mm)	a	75.5
	b	41.5
	c	33
	d	69
	e	68.5
	f	62.5
	g	84
	h	68
	i	7
	j	4.5
	k	30
	l	13
Cable nominal cross-section area(mm <sup>2</sup> )	1-2.5	2.5-6

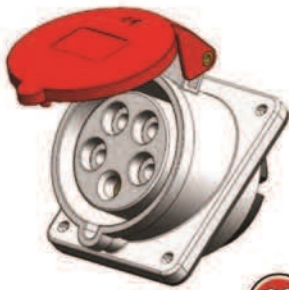

IP44

3P+N+

**C415**  
**C425**

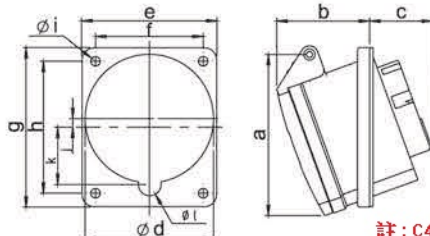

電壓  
防護等級

Voltage(V): 200-346V~  
240-415V~  
Protection degree: IP44



註: C415-6H e:72 f:58

Type	C415	C425
Rated current(A)	16	32
Dimension(mm)	a	75.5
	b	41.5
	c	33
	d	69
	e	78.5
	f	62.5
	g	84
	h	68
	i	7
	j	4.5
	k	30
	l	13
Cable nominal cross-section area(mm <sup>2</sup> )	1-2.5	2.5-6

3  2P+⊕	4  3P+⊕	5  3P+N+⊕	<b>100-130V</b> 50 a.60Hz 3pol. 4pol. 5pol. 4h 4h 4h	<b>200-250V</b> 50 a.60Hz 3pol. 4pol. 5pol. 6h 9h 9h	<b>346-415V</b> 50 a.60Hz 3pol. 4pol. 5pol. 9h 6h 6h	<b>480-500V</b> 50 a.60Hz 3pol. 4pol. 5pol. 7h 7h 7h	<b>&gt;50-500V</b> 100-300Hz 3pol. 4pol. 5pol. 10h 10h 10h	<b>&gt;50-500V</b> 300-500Hz 3pol. 4pol. 5pol. 2h 2h 2h
--	--	--	---	---	---	---	---	--

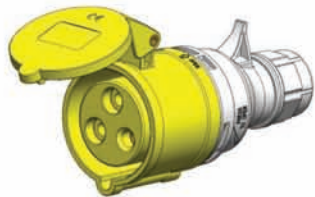

IP44

2P+⊕

**C213-4** 電壓 Voltage(V):100-130V~  
**C223-4** 防護等級 Protection degree: IP44

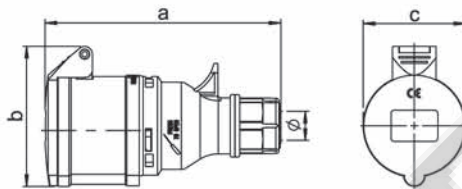

Type	C213-4	C223-4
Rated current(A)	16	32
Dimension(mm)	a	121
	b	69.5
	c	50
	φ	8-14
Cable nominal cross-section area(mm <sup>2</sup> )	1-2.5	2.5-6



IP44

2P+⊕

**C213** 電壓 Voltage(V):200-250V~  
**C223** 防護等級 Protection degree: IP44

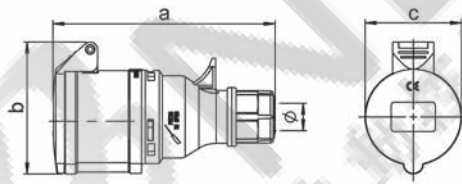

Type	C213	C223
Rated current(A)	16	32
Dimension(mm)	a	121
	b	69.5
	c	50
	φ	8-14
Cable nominal cross-section area(mm <sup>2</sup> )	1-2.5	2.5-6

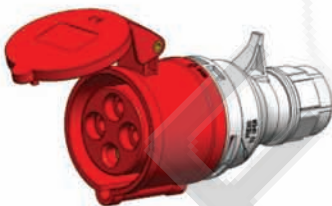

IP44

3P+⊕

**C214** 電壓 Voltage(V):380-415V~  
**C224** 防護等級 Protection degree: IP44

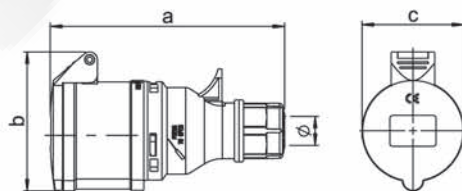

Type	C214	C224
Rated current(A)	16	32
Dimension(mm)	a	125.5
	b	78
	c	56.5
	φ	8-14
Cable nominal cross-section area(mm <sup>2</sup> )	1-2.5	2.5-6

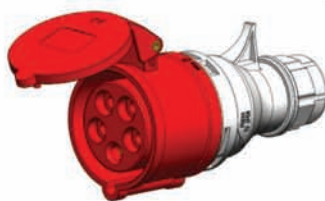

IP44

3P+N+⊕

**C215** 電壓 Voltage(V): 200-346V~  
**C225** 防護等級 Protection degree: IP44

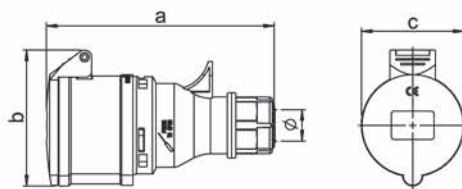

Type	C215	C225
Rated current(A)	16	32
Dimension(mm)	a	132
	b	87
	c	64
	φ	10-19.5
Cable nominal cross-section area(mm <sup>2</sup> )	1-2.5	2.5-6